

Basic characteristics

1. Block diagram

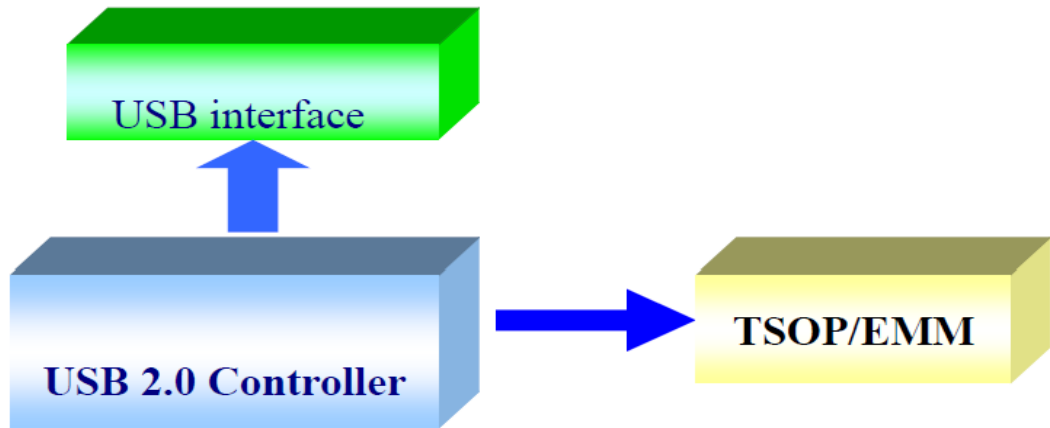

2. Dimension figure

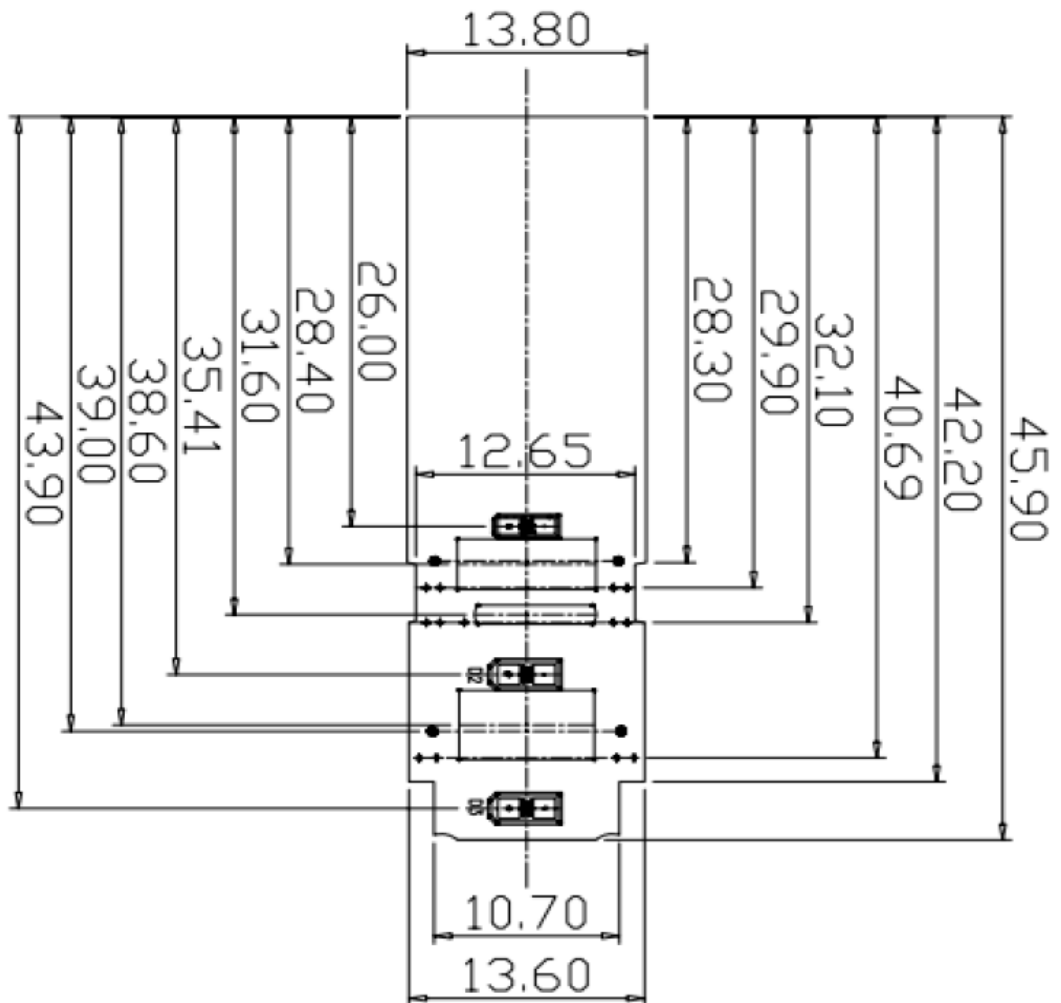

Dimension figure 1

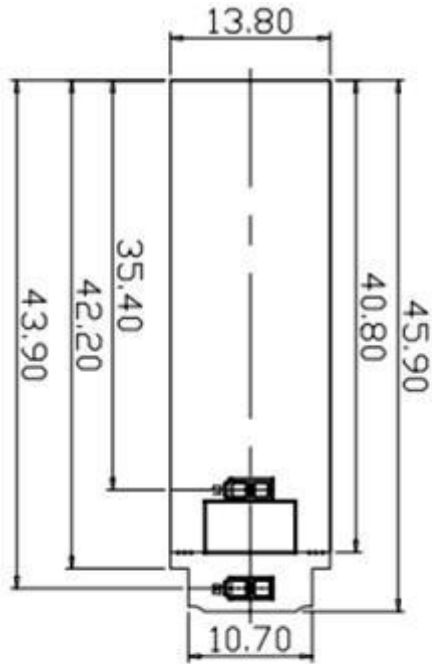

Dimension figure 2

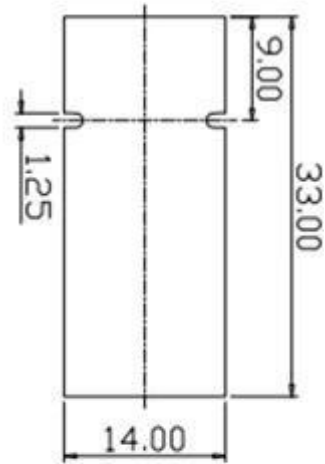

Dimension figure 3

3. USB capacity range description (reference value)

1GB	2GB	4GB	8GB	16GB	32GB	64GB	128GB
960MB	1.86GB	3.72GB	7.44GB	14.88GB	29.76GB	59.53GB	119.07GB
3MB/S	3MB/S	3MB/S	3MB/S	3MB/S	4MB/S	5MB/S	6MB/S
10MB/S	10MB/S	12MB/S	12MB/S	12MB/S	13MB/S	13MB/S	13MB/S

Test environment: WindowsXP SP3, Intel P55 Motherboard, 4GB DDRIII DRAM, Intel Core i5 750

Test Tool: FDBENCH 1.02

4. USB properties requirements

- Power supply: USB bus
- Input voltage
Typical voltage: USB standard 5V voltage
- Working current: Max 100 mA @ 5.0 V DC (typical)
- USB interface specification: USB 2.0 (480Mbps)
- USB interface plugging number: 10000 times
- Working environment

Working temperature	-10°C—+55°C
Storage temperature	-20°C—+70°C
Relative humidity	10~95% (no condensation water)

5. Outside view

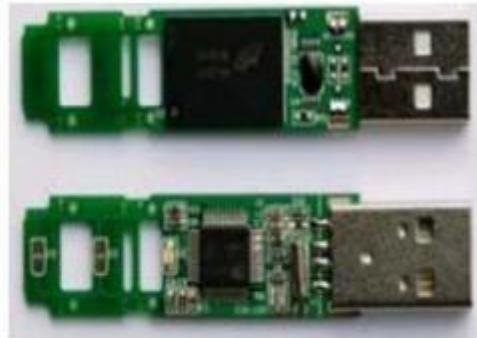

UPA-A(a)



UPA-A(b)



UPA-T

6. LED description

Red LED is the default LED. The entity corresponds to UPA-A(a) is multi-shape board, there is a row of stamp holes between the tail part of the board and the motherboard, which is facilitate to amputate the tail part of the board to accommodate different length shells. The default location of LED is close to the USB head lights.

Noted: The location and color of LED is optional. Moreover, the LED is dispensable – the whole UPA can work normally with or without it.