

4760-74

Series 4760-4774 General Purpose Vessels: 160 - 600 mL

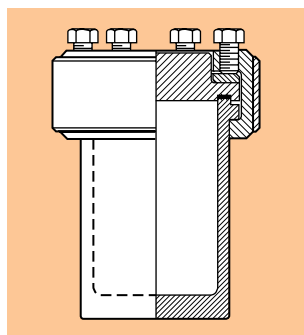

Cross Section 4760

Model 4761,
300 mL Vessel
with 4316 Gage
Block AssemblyModel 4761,
300 mL Vessel
with A281HC
Adapter
and A146VB
Needle ValveModel 4760,
300 mL Vessel
with Blank
Head

Series 4760 - 4774 Pressure Vessel Specifications

Shaded bar indicates specifications that change within series.

Model Number	4760(Q)*	4761(Q)*	4766(Q)*	4762(Q)*	4763(Q)*	4767(Q)*
Sizes, mL	300			450		
Maximum Pressure	3000 psi (200 bar)					
Maximum Temperature						
with FKM O-Ring	225 °C					
with PTFE - Flat Gasket	350 °C					
Closure (Cap Screws)	Split-Ring (6)					
Gasket	O-Ring - FKM or Flat - PTFE					
Vessel Dimensions						
Inside Diameter, inches	2.5					
Inside Depth, inches	4.0			6.0		
Weight of Vessel, pounds	9			10		
Head Style						
Opening	Blank	“A” Socket	“A” Socket	Blank	“A” Socket	“A” Socket
Thermowell	No	No	Yes	No	No	Yes
Heater						
Catalog Number	A2230HC			A2230HC2		
Wattage	400			590		
Style	Mantle					
Mounting	Bench Top					
Maximum Head Openings	5					
Recommended Gage Block	4316					
*add the suffix Q to these catalog numbers to specify vessels with an O-Ring seal and a split ring pair without cap screws						



**Model 4766Q,
300 mL Vessel,
with A281HC
Adapter, A146VB
Needle Valve, and
Thermocouple**



**Model 4768Q,
600 mL Vessel,
with 4316 Gage
Block Assembly,
and Thermocouple**

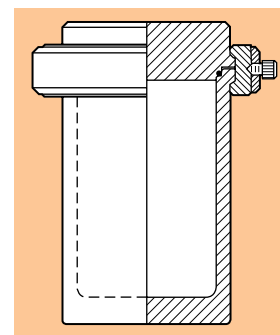

Cross Section 4760Q

Series 4760 - 4774 Pressure Vessel Specifications

Shaded bar indicates specifications that change within series.

Model Number	4764(Q)*	4765(Q)*	4768(Q)*	4772(Q)*	4773(Q)*	4774(Q)*
Sizes, mL	600			160		
Maximum Pressure	3000 psi (200 bar)					
Maximum Temperature						
with FKM O-Ring	225 °C					
with PTFE - Flat Gasket	350 °C					
Closure	Split-Ring					
Gasket	FKM O-Ring or Flat - PTFE					
Vessel Dimensions						
Inside Diameter, inches	2.5					
Inside Depth, inches	8.0			2.0		
Weight of Vessel, pounds	11			7		
Head Style						
Opening	Blank	“A” Socket	“A” Socket	Blank	“A” Socket	“A” Socket
Thermowell	No	No	Yes	No	No	Yes
Heater						
Catalog Number	A2230HC3			A2235HC		
Wattage	400			500		
Style	Mantle			Clamp-on		
Mounting	Bench Top					
Maximum Head Openings	5					
Recommended Gage Block	4316					
*add the suffix Q to these catalog numbers to specify vessels with an O-Ring seal and a split ring pair without cap screws						